



AML Clone Utility (PC)



1. Create a Clone File

Tap the AML Clone icon.

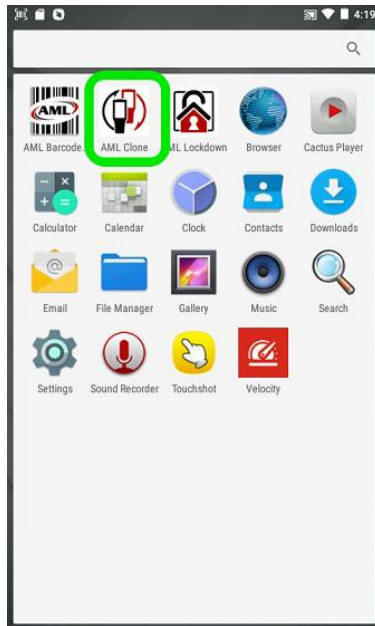

2.

Tap "Clone this Device".

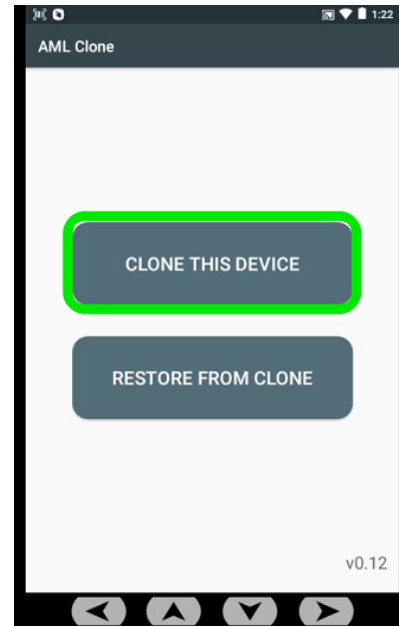

3.

- Tap **Internal Storage** → **Download** → **Select**
 - Allow the process to complete: **Please wait**

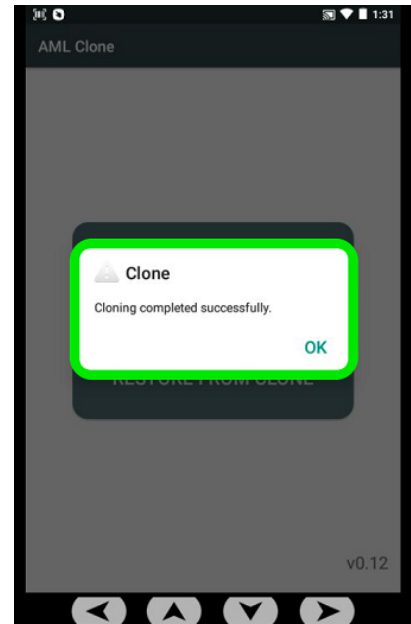
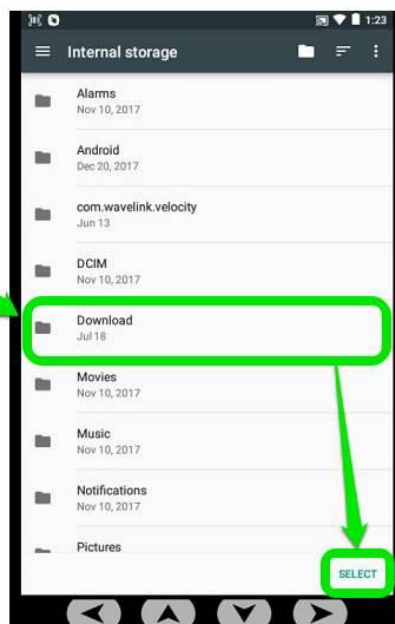
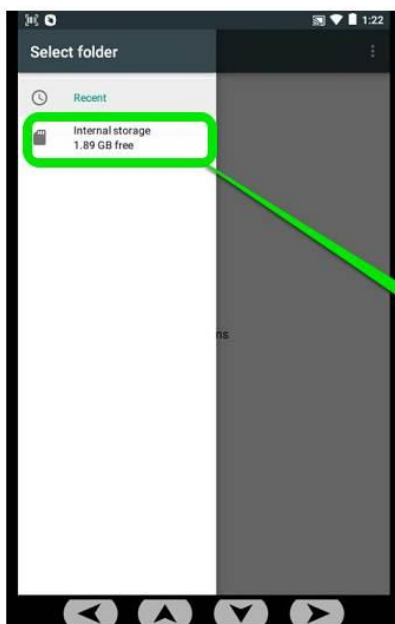

4.

- Place the Scepter in the charging cradle.
- Connect the cradle to a PC using a USB cable.
- Swipe down from the top of the screen



5.

- Tap **USB for charging**
 - select **File Transfers**.

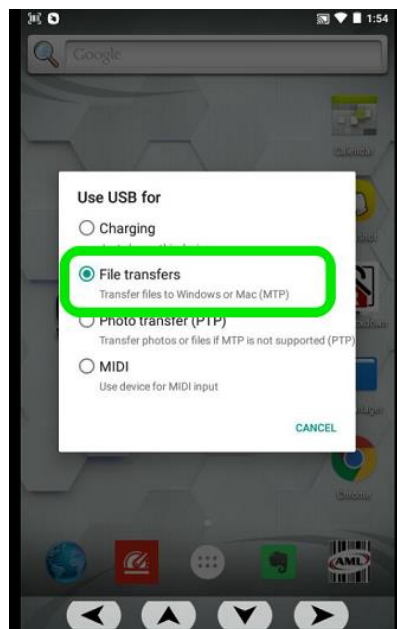

6.

- Save the Scepter clone file to your PC:
 - Open Windows File Explorer on the PC (*keyboard shortcut: Windows key+E*):
- Browse to:
 - **Computer** → **Scepter** → **Internal Storage** → **Download**:

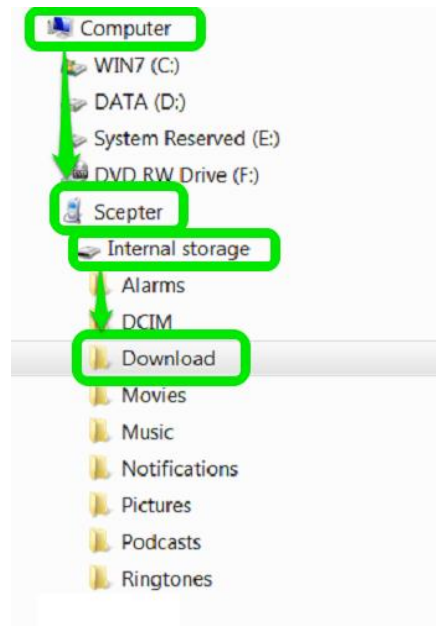

7.

- Transfer the "AML Clone" File from the Scepter to the PC:

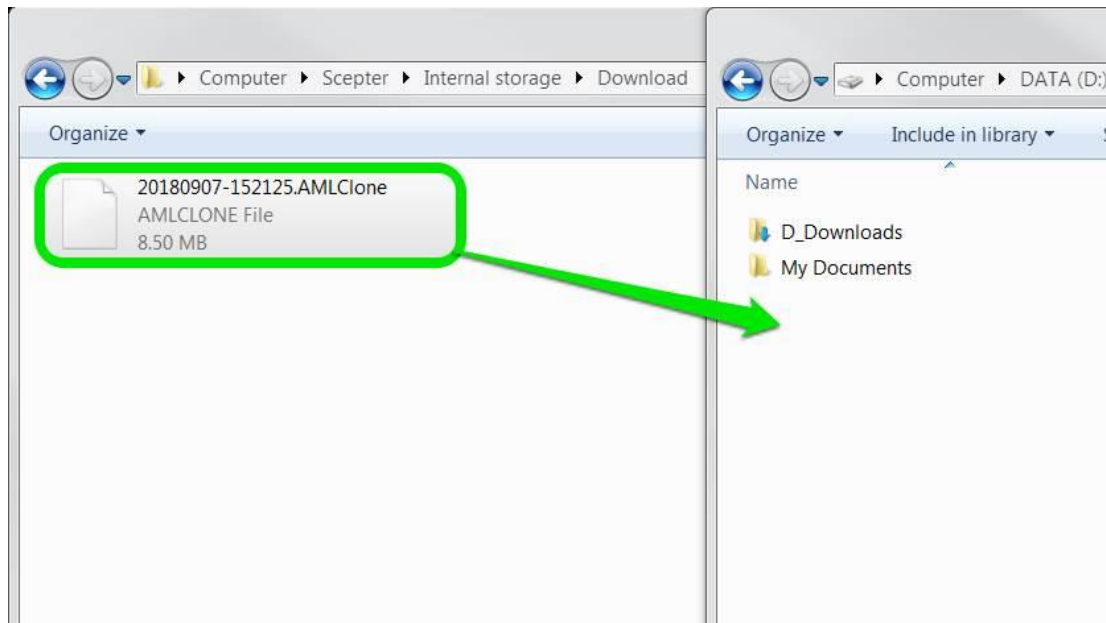

1. Cloning Another Scepter

- Place the Scepter in the charging cradle (connected via USB to PC).
- Swipe down from the top of the screen.



2.

- Tap **USB for Charging...** then **File Transfers**.

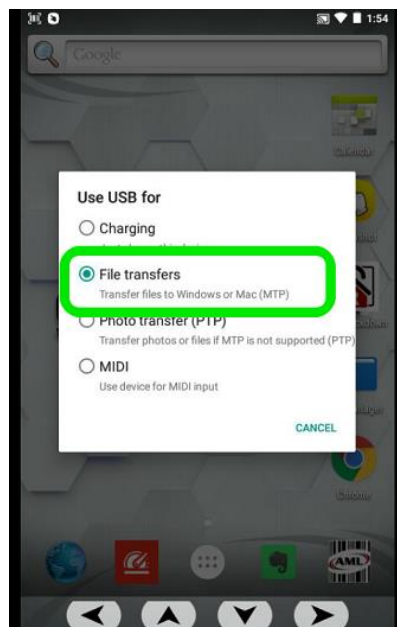

3.

- Open Windows File Explorer on the PC (*keyboard shortcut: Windows key + E*):
- Browse to:
 - **Computer** → **Scepter** → **Internal Storage** → **Download**:

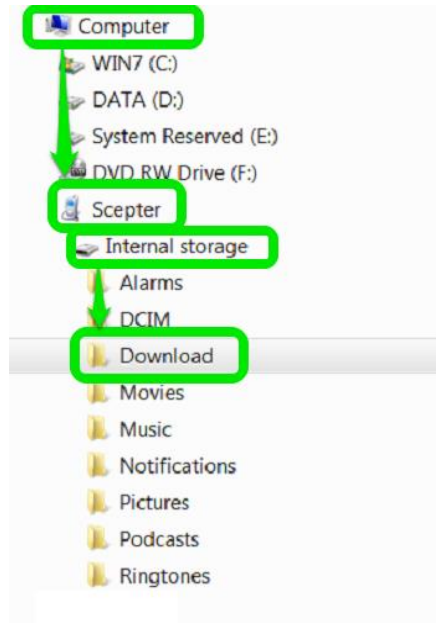

4.

- Transfer the ".AMLCClone" file from the PC to Scepter:

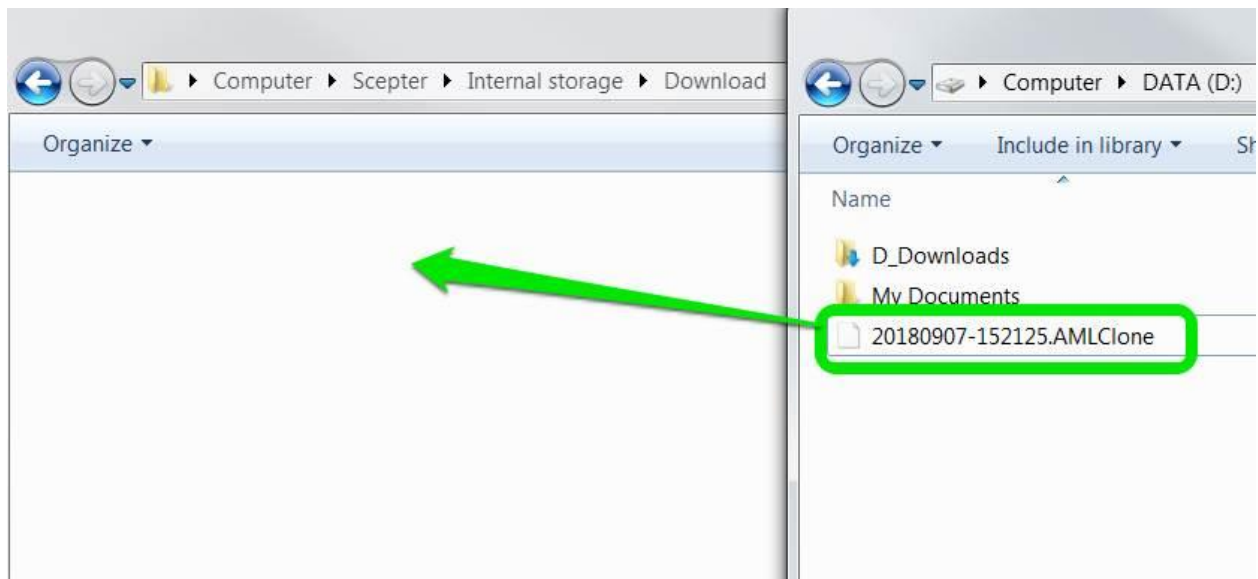

5.

- Tap the *AML Clone* application icon:

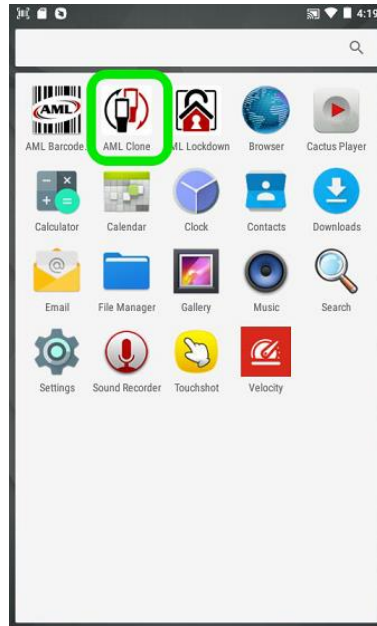

6.

- Choose **RESTORE FROM CLONE**.

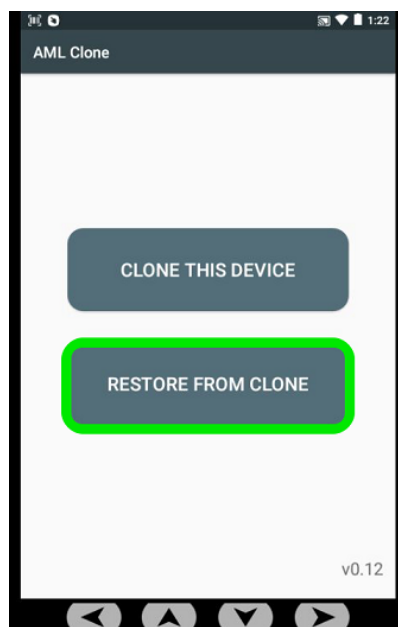

7.

- Navigate to **Internal Storage** → **Download**

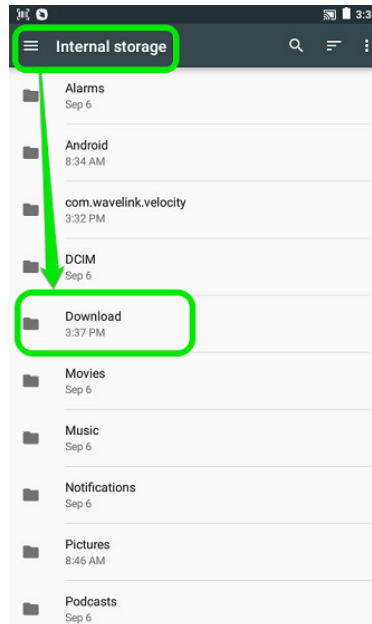

8.

- Tap the ".AMLClone" file → **Yes** to begin cloning (*note: the device will reboot upon completion*).

