

Dragonfly

Wearable Computer Quick Reference Guide



7361 Airport Freeway, Richland Hills, Texas 76118
800-648-4452 www.amltd.com

050924



SPECIFICATIONS

Operating System	Android 13+
Processor	Qualcomm QCS6490 8x Kryo 670 CPU up to 2.7GHz
Dynamic RAM	4GB Dual Channel LPDDR4
Flash Memory	64GB
Display	4.3" 800 x 480 IPS LCD, Gorilla Glass 5
Touchscreen	Projected Capacitive Multi-touch
Optional Tactile Keypad	21-key Numeric with Alternative Alpha
WLAN	802.11ax (Wi-Fi 6E)
WPAN	BLE 5.2 Dual Mode
Main Battery	18.5 watt-hour, 3.7V, 5000 mAh
Barcode Scanning	Wireless options
Other Features	3 axis Accelerometer / Gyro Ambient Light / Proximity Sensor NFC Reader LED Flashlight
Size	4.8" x 3.7" x 0.8" (12.2cm x 9.4cm x 2cm)
Weight	9.5 oz (269g)
Environmental Rating	IP65
Operating Temperature	-4° to 122° F (-20° to 50° C)
Tumble Rating	1,000 tumbles @ 3.3ft/1m

Sanitizing your Dragonfly

The best way to clean and sanitize your AML mobile is to use a diluted solution of three-parts water and one-part rubbing alcohol. Rubbing alcohol is a diluted form of isopropyl alcohol. It typically contains 70% isopropyl alcohol with the balance consisting of other denaturants. Do not use full-strength isopropyl alcohol.

Apply the solution to a soft cloth first, and then wipe all surfaces of the device.



PRODUCT REGISTRATION AND WARRANTY

Please Register Your Product

In order to help facilitate support inquiries, please register your product.

You can register online at:

www.amltd.com/register



AML Technical Support Team

AML technical phone support is toll-free and pain-free. Speak with a US-based AML employee trained to answer your question and do everything possible to resolve any issues that might arise.

877-842-3990 Mon-Fri, 8:00 to 5:00 CST.

Your Dragonfly Wearable Computer has a 12-month factory warranty that begins on the date of purchase. It covers parts and labor defects but does not cover damage as the result of abuse or neglect. Consider purchasing an extended warranty for broader coverage.

If your Dragonfly Wearable Computer is in need of repair, you may request an RMA number (Return Material Authorization) by calling **877-842-3990**, between 8:00 am and 5:00 pm, (CST) Monday-Friday.

You may also request an RMA number online at: <https://www.amltd.com/RMA-Request>



Do I have the coverage I need? UPGRADE YOUR WARRANTY TODAY!

Extended Warranty & Extended Warranty PLUS include:

- Covers the failure of internal components as a result of normal wear and tear.
- Covers firmware upgrades.
- Four (4) business-day turnaround, excluding time in transit, when RMA number is properly marked on the outside of the box.
- Standard return freight (UPS ground) included.



The **Extended Warranty PLUS** also includes coverage for failure of external components regardless of fault.*

*Some Exclusions Apply.

Contact AML for further details

www.amltd.com

800.648.4452

DEVICE LAYOUT

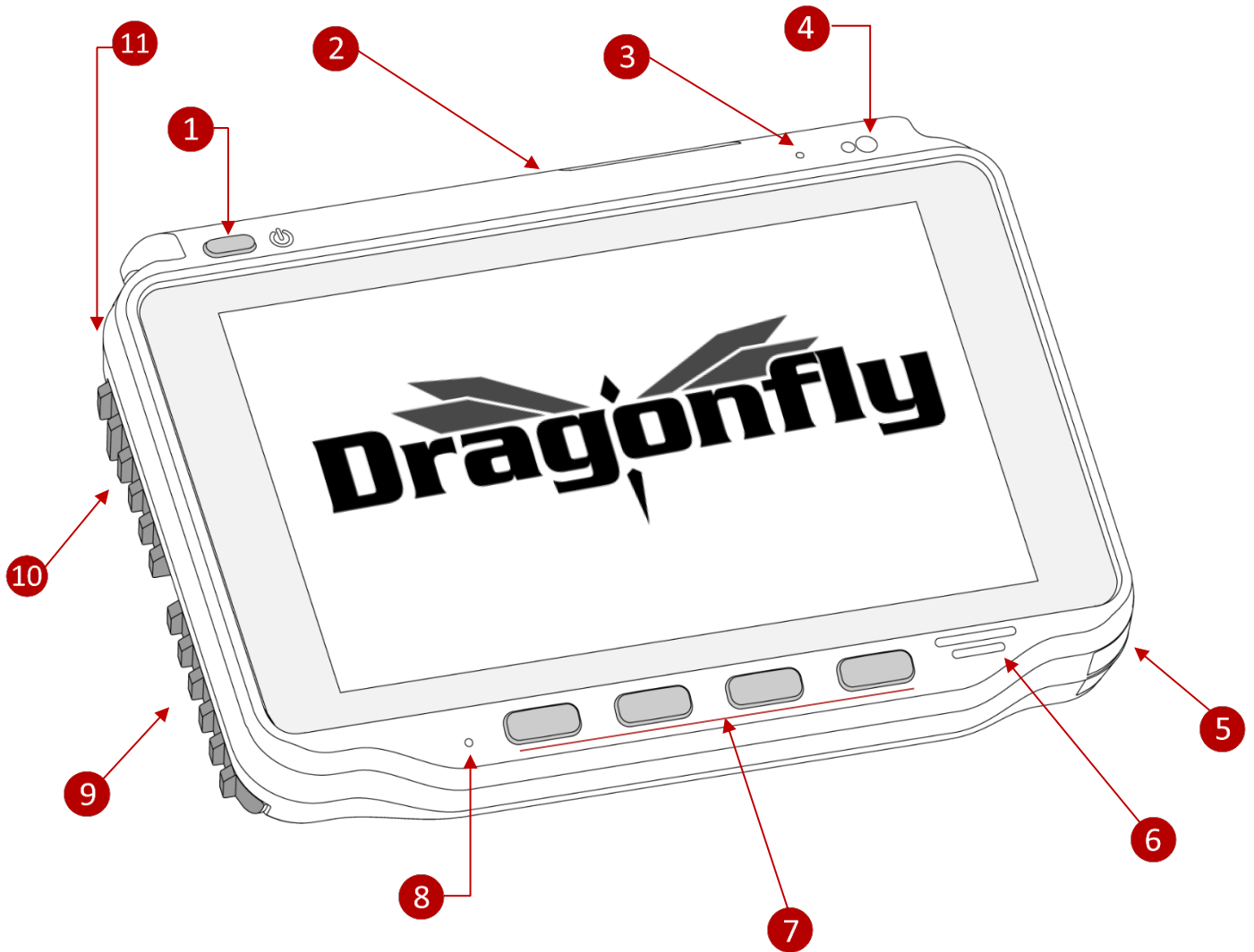

1	Power Button, Charge Indicator, Suspend/Resume
2	Charging Port, USB Communications
3	Microphone
4	Light Sensor, Proximity Sensor
5	Accessory Port Cover
6	Speaker
7	Programmable Buttons
8	Microphone
9	Arm Base Attachment Lock
10	Battery Lock
11	Battery

INCLUDED HARDWARE

BATTERY PACK
(P/N: 180-2170)

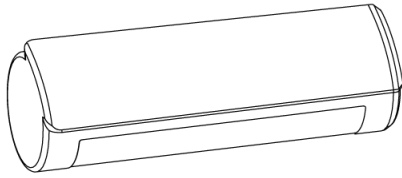

DRAGONFLY WEARABLE COMPUTER
(Base Model: M6500)

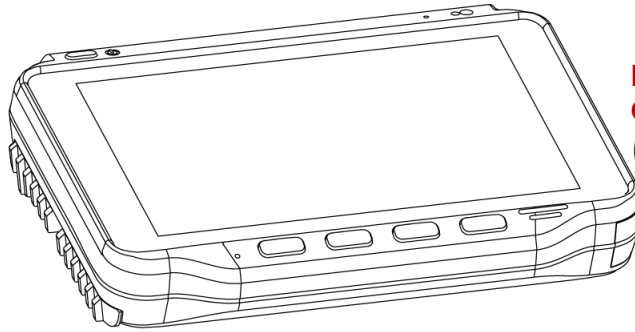

ARM BASE
(P/N: 173-6509)

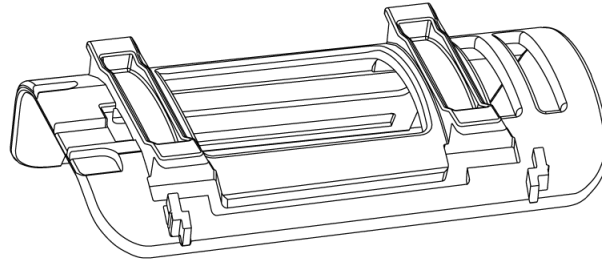

ARM PAD
(P/N: 173-6510)

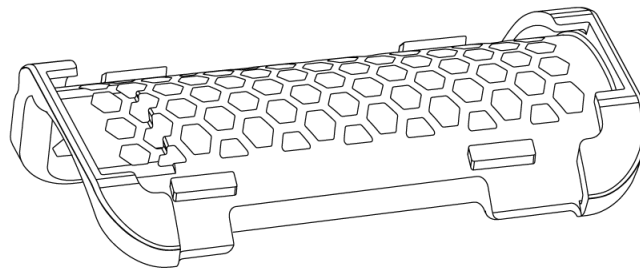

ARM STRAP
(P/N: ACC-6500STR-V)

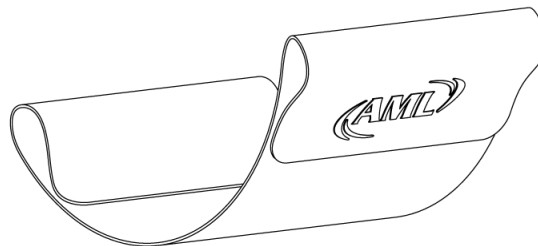

Item	Part Number	Specifications
Dragonfly	M6500 (Base Model)	
Battery Pack	180-2170	18.5Wh, 5Ah, 3.7V, Li-Ion
Arm Base	173-6509	Nylon
Arm Pad	173-6510	Medical Grade Silicone
Arm Strap	ACC-6500STR-V	Velcro Strap

BATTERY AND BASE LOCKS

The locking mechanisms for both the Battery and the Arm Base can be found on the left side of the Dragonfly.

The Battery lock is highlighted in **red**, and the Arm Base lock is highlighted in **blue**.

Slide the locks in the direction indicated to operate.

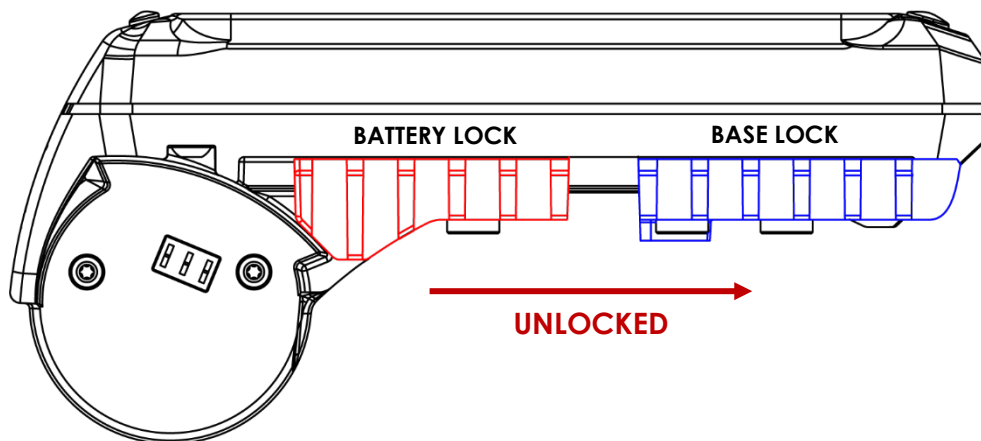
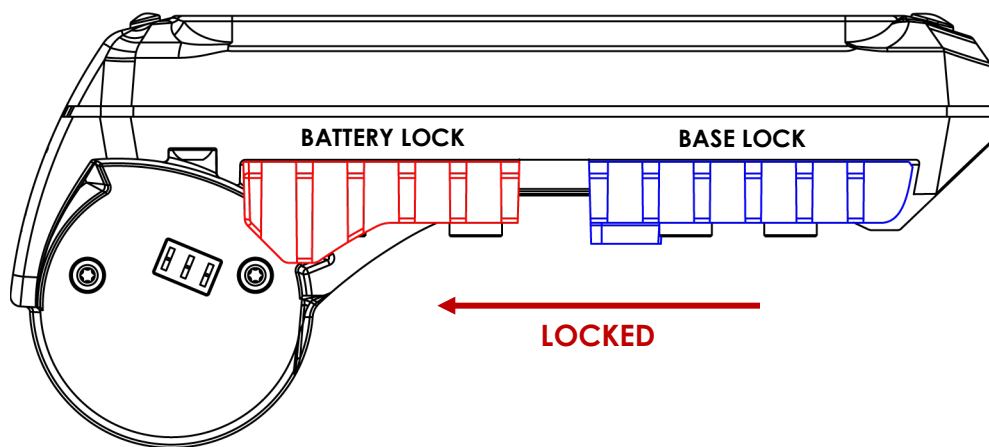

INSTALLING THE BATTERY

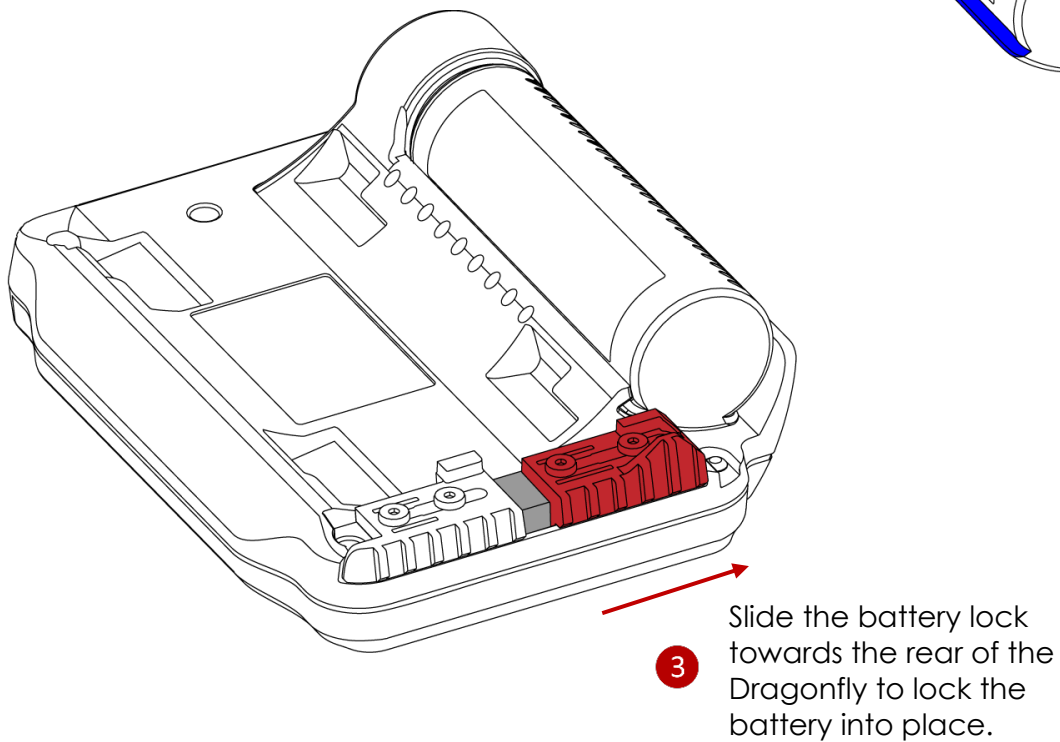
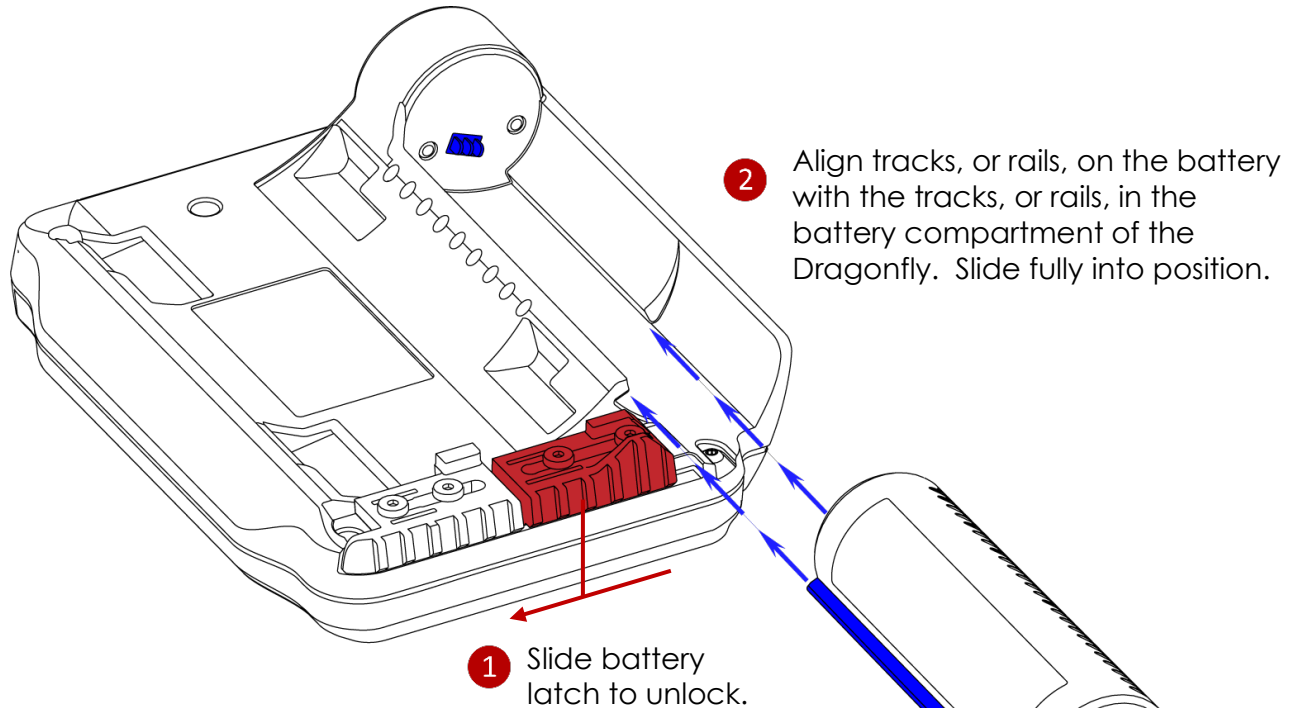

There should be no gap between the battery pack housing and the Dragonfly. If there is, the battery is not properly aligned between the rails.



BATTERY CARE

Adequate battery life is crucial to the performance of mobile computing devices. Here are some tips for prolonging the life of your Dragonfly batteries:

- Charging your batteries at room temperature is recommended. Charging at lower temperatures will require a longer charge time and charging below freezing can permanently damage battery cells, making them more sensitive to failure when exposed to vibration and other stresses. Charging at elevated temperatures (above 40°C / 104°F) is also not supported as it can create a possible thermal runaway condition that can also permanently damage a battery cell.
- Avoid discharging the batteries completely. The shorter the discharge, the longer the battery lasts. There is no issue with “memory” and the battery does not need periodic full discharge cycles to prolong life.
- Avoid storing batteries with a full charge. If you purchase batteries to be used as replacements in the future, avoid the urge to fully charge them and then set them on the shelf. Instead, place them in a cool, dry place and then wait to charge them fully when you’re ready to use them. Ideally, Li-ion batteries should be charged at 40 percent for long-term storage. The worst possible scenario is a fully charged battery stored at an elevated temperature.
- Date-stamp your batteries when you receive them. If you use the “500-cycle rule” – meaning that your battery should last about 500 charges – you can calculate about how long your batteries are expected to work at 80 to 100% of full capacity. It’s important to note that Lithium-Ion batteries do just simply age, regardless of charge cycles. If a battery is five years old, even if it’s only used once a month, it will still not perform at full capacity.

BATTERY CHARGING

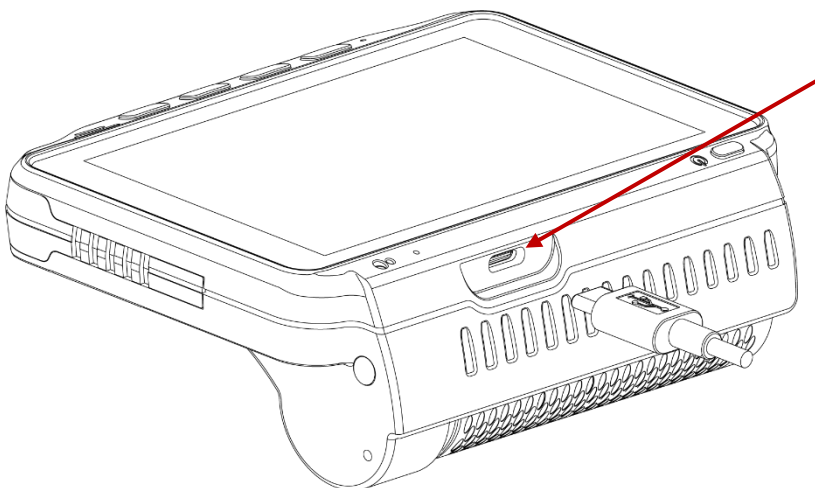

Charge the Dragonfly with a USB-C cable connected to a power supply capable of delivering 5 volts DC at a minimum of 1 amp.

Alternatively, the ACC-2170 battery charger can charge 5 batteries simultaneously.



ARM BASE, PAD, STRAP

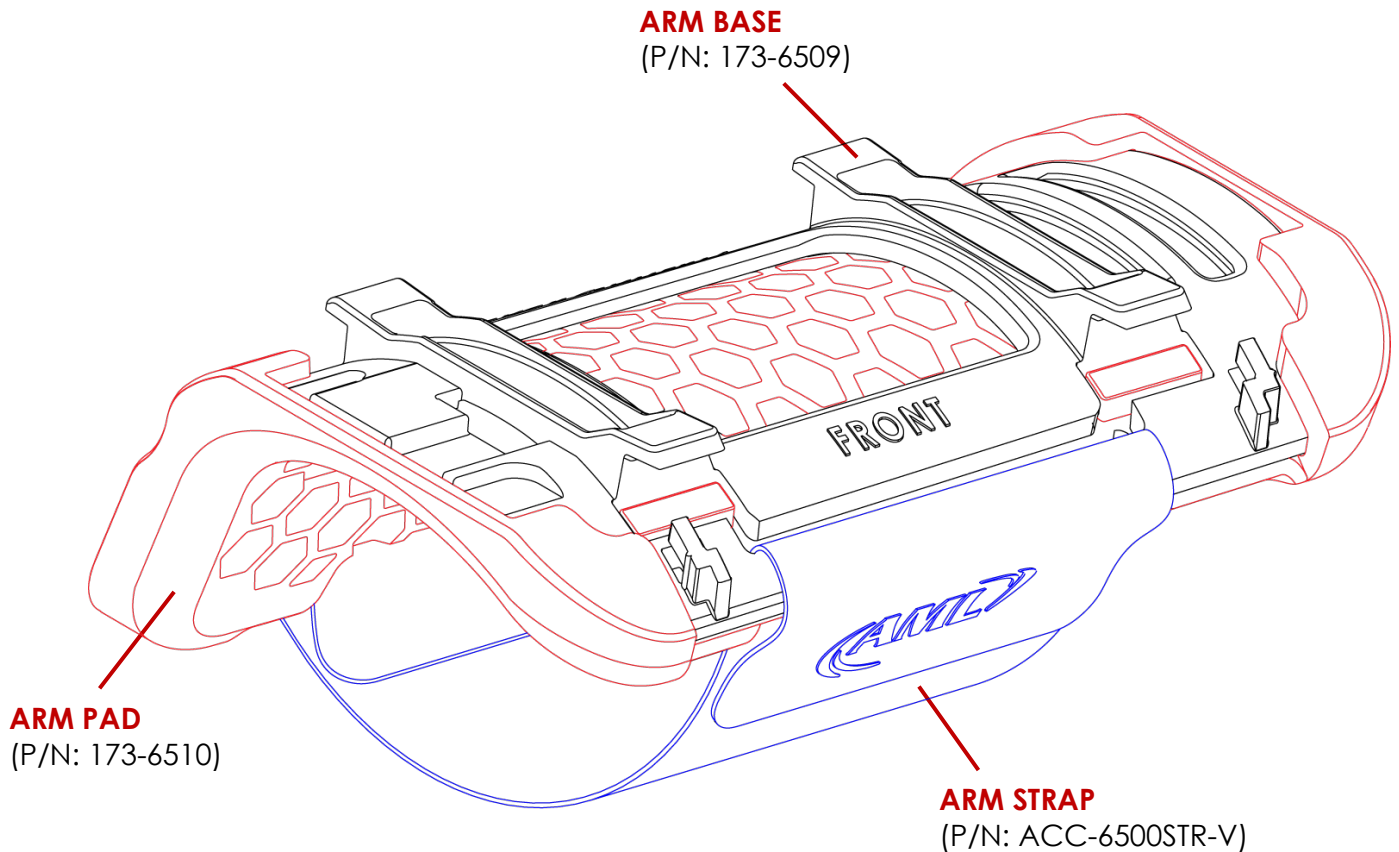

<p>ARM BASE P/N: 173-6509</p> <p>Made of durable and flexible nylon.</p>	<p>The Arm Base mounts to the underside of the Dragonfly and provides a stable base interface between the Dragonfly and the user's arm. It is primarily intended to be worn on the left arm. The nylon material flexes to contour to the user's arm.</p>
<p>ARM PAD P/N: 173-6510</p> <p>Made of medical grade silicone with a soft touch surface.</p>	<p>The Arm Pad is mounted to the Arm Base, and provides a comfortable, breathable soft surface that can be worn directly onto the skin or clothing. The soft touch provides a non-slippery fit and can be easily removed and washed with either soap and water or isopropyl alcohol.</p>
<p>ARM STRAP P/N: ACC-6500STR-V</p> <p>Universal fit seamless Velcro strap.</p>	<p>The Arm Strap features double adjustable ends for a universal fit and is made of washable and breathable fine-woven felt for all-day comfortable wear.</p>

INSTALLING THE ARM PAD

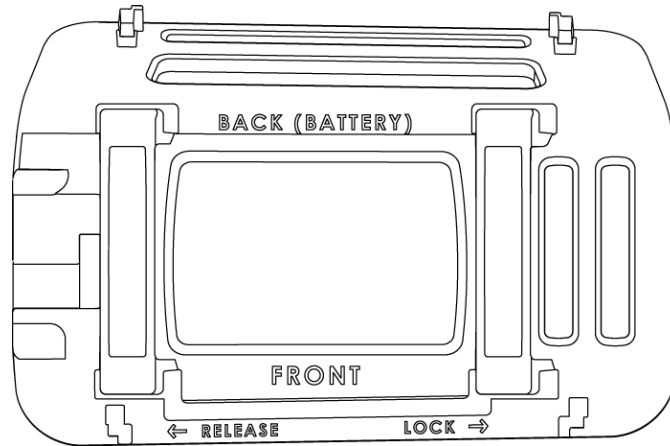

Three "tabs" on the left.

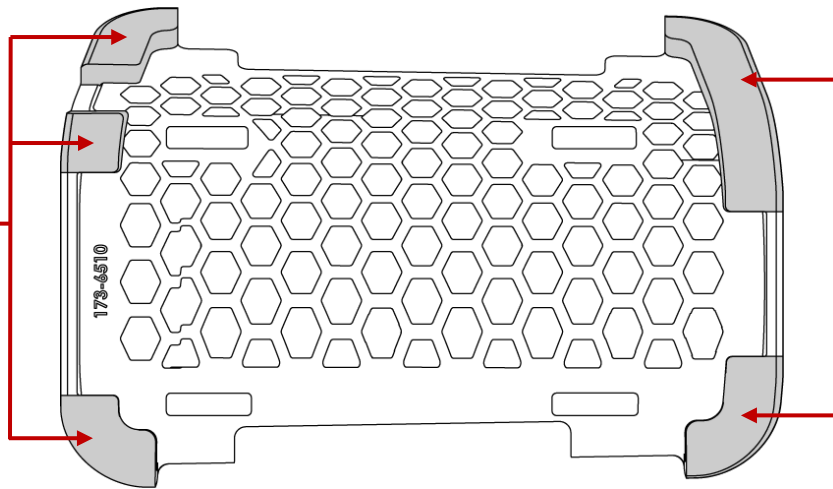

Two "tabs" on the right.

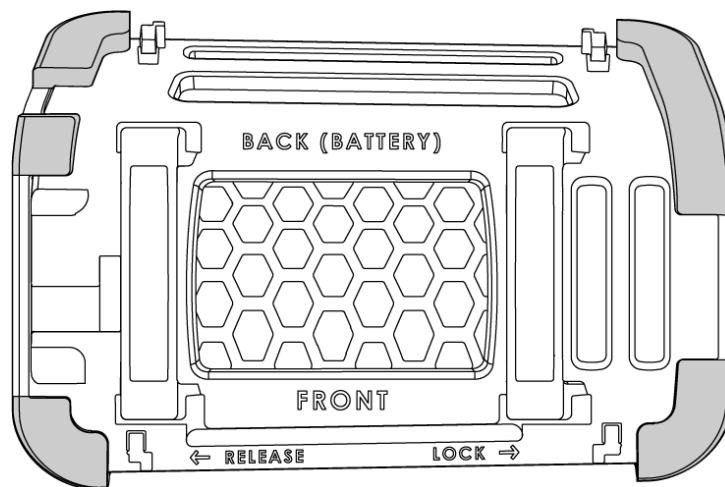

Secure the silicone Arm Pad to the Arm Base by slightly bending and overlapping the ends around the left and right edges of the Arm Base.

INSTALLING THE ARM STRAP

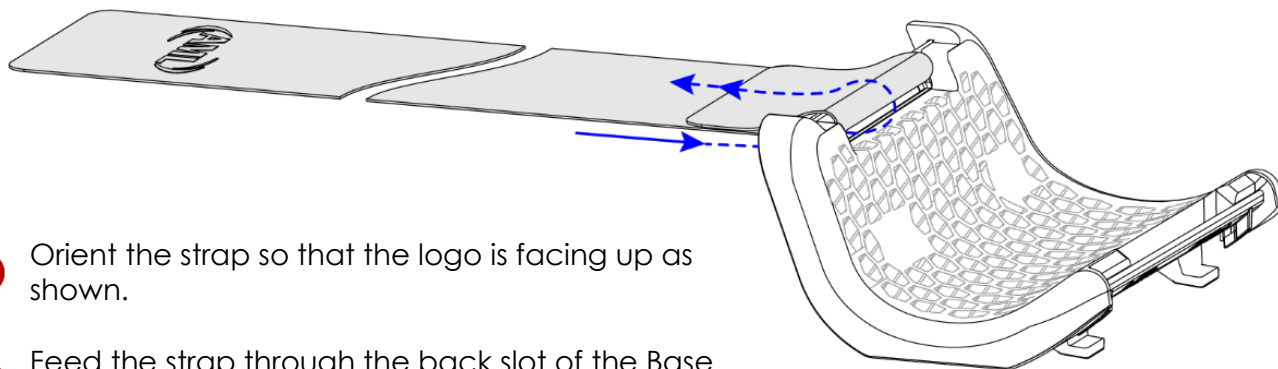

- 1 Orient the strap so that the logo is facing up as shown.
- 2 Feed the strap through the back slot of the Base from the outside.

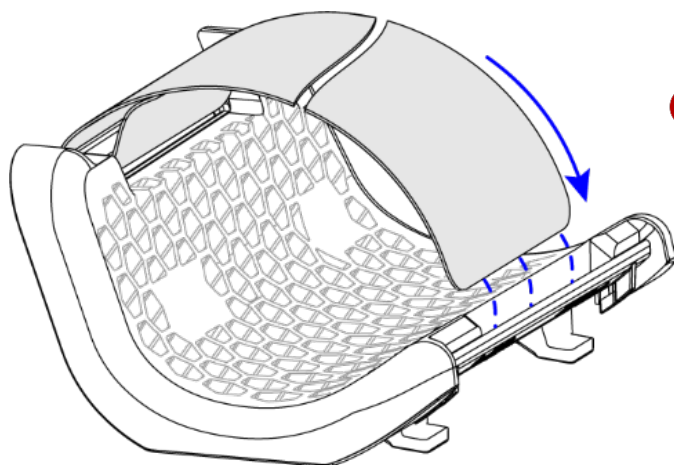

- 3 Feed the strap through the front slot of the Base, from the inside.

- 4 Loop back and fasten the strap onto itself, at the desired length to control the tightness on the arm.

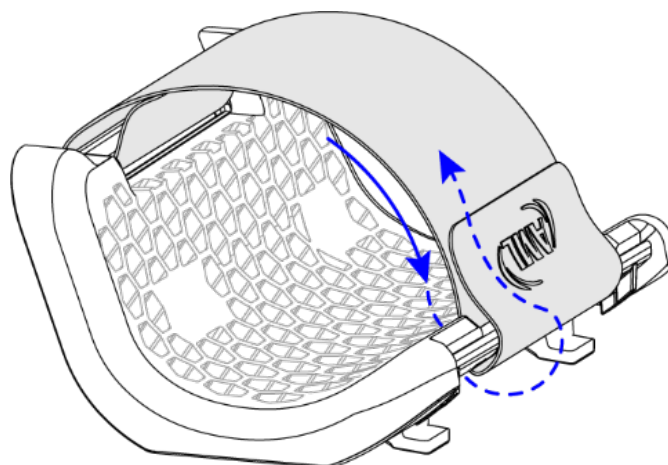

INSTALLING THE DRAGONFLY TO THE BASE

- 1 Unlock the device lock.

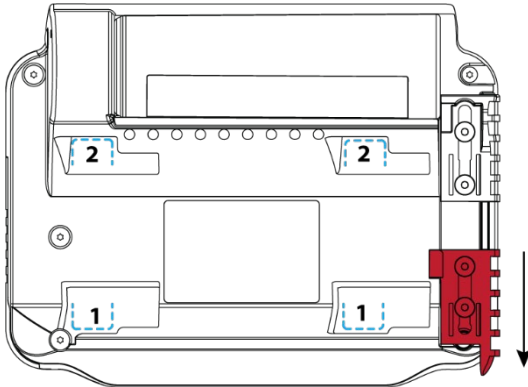

- 2 Line up the tabs on the base with the slots on the Dragonfly. Line up the FRONT tabs first.

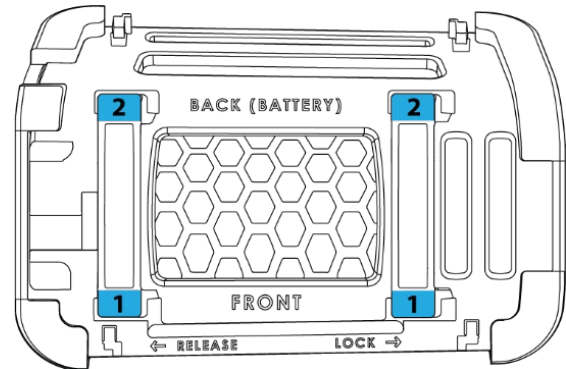

- 3 Line up the tabs and slide the base towards the lock position to engage with the Dragonfly.

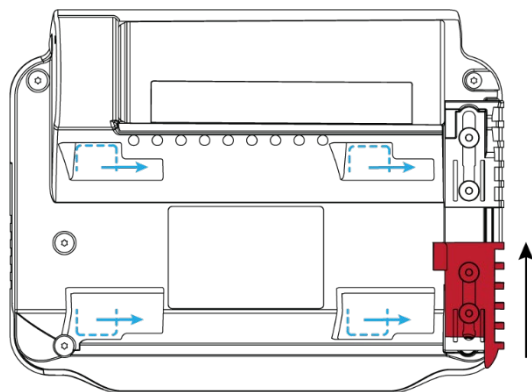
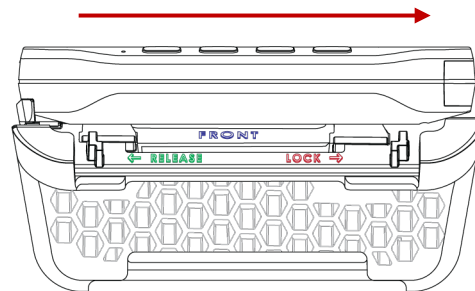
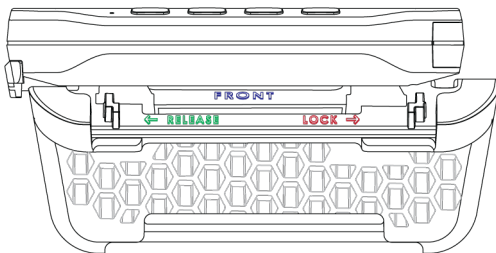

- 4 Re-engage the device lock.

Installing the Dragonfly onto the base.



Removing the Dragonfly from the base.



WEARING THE BASE

Because arms vary greatly in size and shape, we recommend that you determine the ideal position on your arm where it (a) feels comfortable and (b) feels secure.

Wearing the Base nearer to the elbow instead of the wrist may improve the balance of the device but may not be the most secure. Wearing it close to the wrist may feel more secure but may accentuate the weight of the device. It is important to find the optimal position for you personally.

Securing the Base while the thumb is pointing upward naturally sets Dragonfly at an optimum angle on the arm for easy reading and interaction with the device.

The thumb should be pointed upward when putting on the Base.

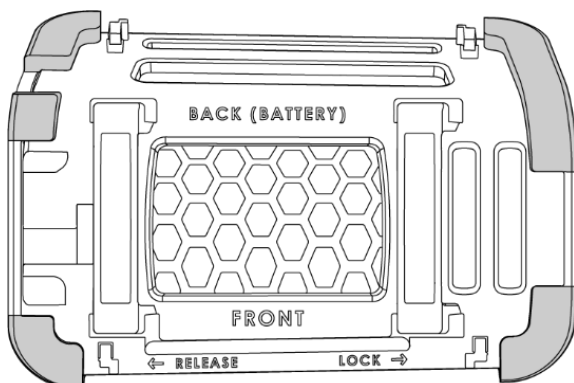
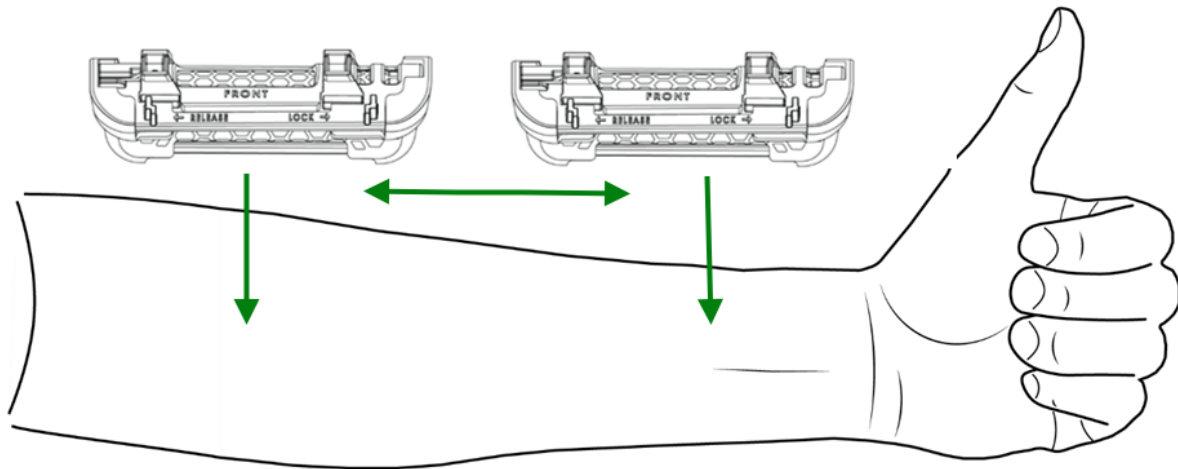

Note the proper orientation of the Base on the arm:

"Back" should be towards the outside of the arm, away from the body.

"Front" should be facing towards the body, on the inner side of the arm.

POWER BUTTON / STATUS LED

STATE / ACTION	INDICATION / BEHAVIOR
The LED is off.	Device not plugged in.
Press and hold for 2 seconds while the device is off.	Device turns on.
Momentary press while the device is on.	Turns sleep mode ON or OFF.
Press and hold while the device is on.	Android "Turn Off" or "Restart" options. Follow the prompts on the screen.
Momentary press while the device is off.	Does not turn on device, but quick flash green LED and quick vibration, confirms device has power.
The LED is GREEN.	Device charging. Battery level is high/fully charged.
The LED is YELLOW.	Device charging. Battery level is medium.
The LED is RED.	Device charging. Battery level is low.
The LED is flashing RED slowly.	Battery level is low, and the device is not charging.
The LED is flashing RED quickly.	Charge error. Bad battery or the ambient temperature is too cold or too hot.





AML Device Manager is optional device management software written specifically for AML mobile computers and kiosks. It gives IT Administrators the ability to remotely create device configurations for rapid deployment, update firmware and settings and view device performance. It also allows complete remote control of the device for support issues and features two-way messaging and a “find my device” feature. Learn more about AML Device Manager at www.amltd.com/AML-Device-Manager/



AML Setup is device configuration software designed to expedite device deployment by allowing users to scan barcodes to easily, and securely, configure their AML devices. AML Setup Console is a desktop application that works in tandem with AML Setup to create configuration settings and generate the barcodes. Learn more about AML Setup at www.amltd.com/Software/AML-Setup/



AML's AppLync™ Browser is a “locked-down” secure web browser for organizations using web-based applications on their data collection devices and require a high degree of security. The AppLync Browser restricts users from accessing other websites and admin settings are password protected. Learn more about AppLync at www.amltd.com/Software/AppLync.



DC Suite is license-free data collection software that works exclusively with AML mobile computers. Users can quickly and easily create their own barcode data collection applications for a variety of tasks including cycle counts, asset management, check-in/check-out applications and much more. Once the data is collected it is easily transmitted to a host server for import into inventory software or into a spreadsheet. DC Suite even comes with seven pre-written applications, ready to go out-of-the-box. Learn more about DC Suite and DC Console at www.amltd.com/Software/DC-Software.



BARCODE SCANNING



WSC-1600 Wearable Bluetooth Scanner

Versatile 2D imaging barcode scanner scans any barcode in any orientation. Scan distances vary depending on the type and size of barcode, but generally fall into the 2-20 inch range. Weighs 1.52 ounces (43g) with the battery. Typical battery life is 8 hours depending on rate of scanning.



WSC-2700 Wearable Bluetooth Scanner

Long range 2D imaging barcode scanner ideal for warehousing environments. Scan any barcode in any orientation at distances up to 50' away, depending on the size and condition of the barcode. Weighs 2.08 ounces (59g) with battery. Typical battery life is 4 hours depending on rate of scanning.



ACC-WSCH Universal Hand Strap

Accommodates both the WSC-1600 and the WSC-2700 wearable scanners and can be worn on either hand.

SCANNER WIRELESS CONNECTION – BT CONNECT

- 1 Launch the **BT Connect** application found on the Dragonfly home screen. Note that the BT Connect app works only with AML's wearable barcode scanners (WSC series). For all other scanners, use either the pairing app provided by the scanner manufacturer or the conventional Android Bluetooth pairing method.



- 2 Turn on the wearable scanner and scan the barcode displayed on the screen of the Dragonfly.

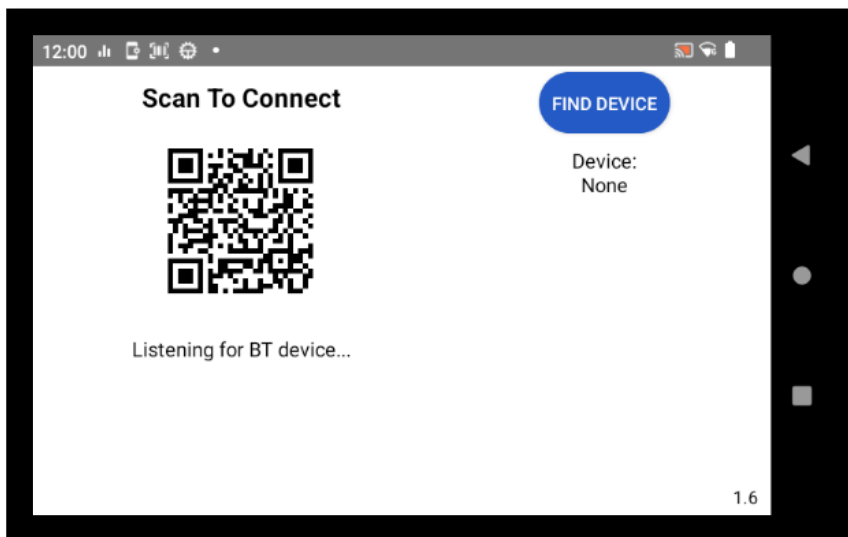

The barcode scanner will disassociate from other devices and only connect with the Dragonfly device you scanned.

The settings configured in the AML Barcode App will then be pushed to the scanner (symbology, suffix, etc.).

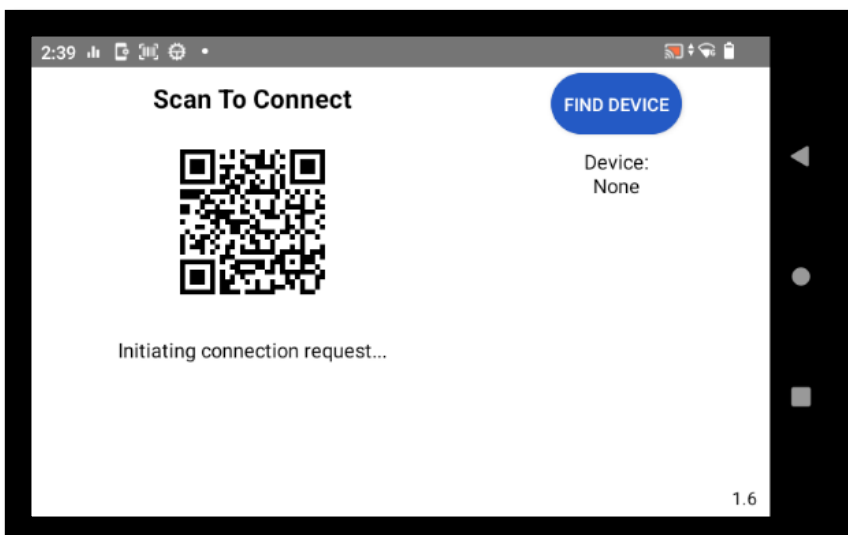

SCANNER WIRELESS CONNECTION – BT CONNECT

Once Connected...

Tap to connect a new scanner. This will bring up the scannable barcode on the screen again. It will automatically disassociate the current scanner if one is connected.

Tap and hold the blue "FIND DEVICE" icon to locate the scanner. The scanner's illuminating light will come on and the device will beep loudly when connected.

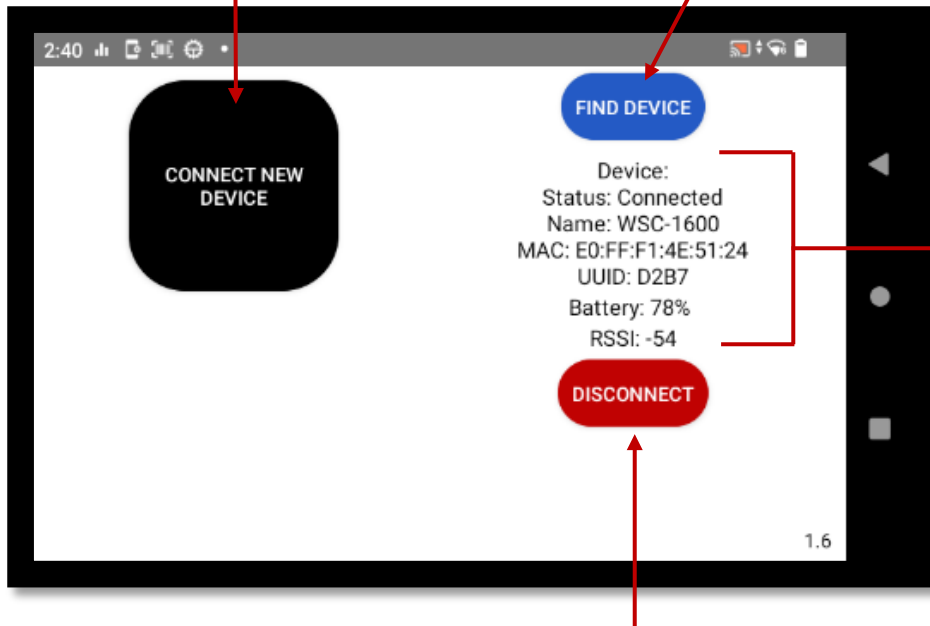

The status dialogue provides information about the scanner connected.

When the battery level dips below 20%, an alarm icon will appear and an audible notification will sound. The alarms will repeat at 15% and again at 10%.

Tap to disconnect a connected scanner.

Note: The wearable barcode scanner will automatically reconnect with the Dragonfly even after a power cycle or when the scanner is back in wireless range of the Dragonfly. In rare cases when a scanner will not connect, please power cycle the barcode scanner and try again. To complete a power cycle, press and hold the trigger button ~6 seconds until the scanner turns off. Press and hold again (~2 seconds) to turn it back on.